



**Exhaust Hose:
Type DSS**



Design: Round, double interlocked special profile

Material:

- Stainless steel Strip 1.4301 (AISI 304), 1.4571, 1.4828
- Special materials on request.

Characteristics:

- Excellent durability.
- High tensile and bending strength.
- High resistance against pressure, impact and mechanical stress.
- Excellent absorption of axial, lateral and angular vibrations.
- Highest gas-tightness and flexibility plus additional protection of exterior contamination.
- Nearly gastight, high flexibility and additional protection against outer soiling.

Applications:

- Used as decoupling element in On- and Off-Road vehicles.

Delivery:

- According to customers' requirements

Contact: Westfalia Metal Hoses GmbH
Am Schwanenweiher 1
57271 Hilchenbach
Germany
eMail: sales-eu@westfalia-mh.com
Phone: +49 2733 283 100



Technical Data

| Order-NO. | Dimension | | Weight compressed length +/- 10% |
|-----------|-----------|---------|--|
| | Inner-Ø | Outer-Ø | |
| | [mm] | [mm] | [kg/m] |
| S61077 | 77,0 | 81,5 | 2,920 |
| S61090 | 90,0 | 94,5 | 3,400 |
| S61102 | 102,5 | 107,0 | 3,850 |
| S61110 | 110,0 | 114,5 | 4,140 |
| S61115 | 115,0 | 119,5 | 4,320 |
| S61120 | 120,0 | 124,5 | 4,510 |
| S61127 | 127,5 | 132,0 | 4,780 |
| S61130 | 130,0 | 134,5 | 4,880 |
| S61140 | 140,0 | 144,5 | 5,250 |
| S61150 | 150,0 | 154,5 | 5,610 |

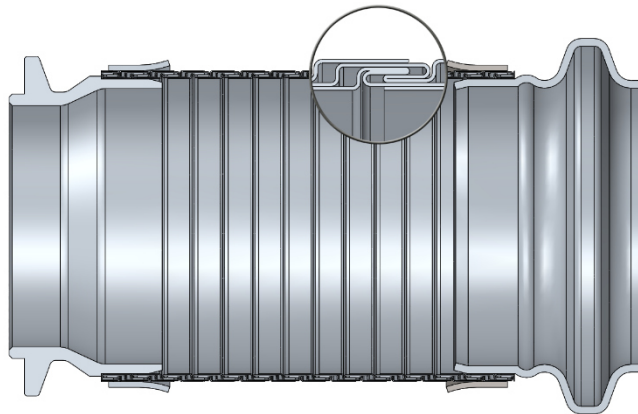

Technical parameters according to customers' requirement. Tolerances on request. Technical data subject to modifications.