



**Exhaust Hose:
Type SSS**



Design: Round, double interlocked special profile

Material:

- Stainless Steel Strip 1.4301 (AISI 304), 1.4828, 1.4539
- Other materials on request

Characteristics:

- Excellent durability
- High tensile and bending strength
- High resistance against pressure, impact and mechanical stress
- Excellent absorption of axial, lateral and angular vibrations
- Compensation of mounting tolerances
- Special winding technique ensures almost complete gastightness with highest flexibility

Applications:

- Used as decoupling element in On- and Off-Road vehicles.

Delivery:

- According to customers' requirements.

Contact:

Westfalia Metal Hoses GmbH
Am Schwanenweiher 1
57271 Hilchenbach
Germany
eMail: sales-eu@westfalia-mh.com
Phone: +49 2733 283 100



Technical Data

| Order-NO. | Dimension | | Weight compressed length +/- 10% |
|-----------|-----------|---------|----------------------------------|
| | Inner-Ø | Outer-Ø | |
| | [mm] | [mm] | [kg/m] |
| S60040 | 40,0 | 43,5 | 0,800 |
| S60050 | 50,0 | 53,5 | 0,980 |
| S60060 | 60,0 | 63,5 | 1,223 |
| S60063 | 63,0 | 66,5 | 1,230 |
| S60077 | 77,0 | 81,0 | 2,780 |
| S60090 | 90,0 | 94,0 | 3,240 |
| S60102 | 102,5 | 106,5 | 3,680 |
| S60110 | 110,0 | 114,0 | 3,940 |
| S60115 | 115,0 | 119,0 | 4,120 |
| S60120 | 120,0 | 124,0 | 4,290 |
| S60127 | 127,5 | 131,5 | 4,550 |
| S60130 | 130,0 | 134,0 | 4,650 |
| S60140 | 140,0 | 144,0 | 5,000 |
| S60150 | 150,0 | 154,0 | 5,350 |

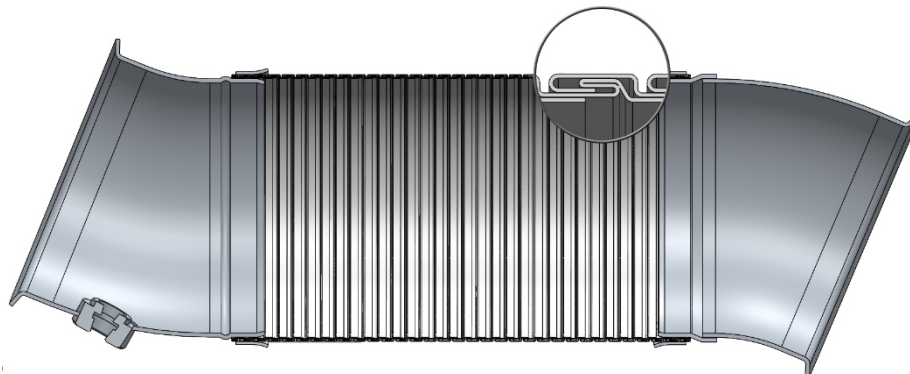

Technical parameters according to customers' requirement. Tolerances on request. Technical data subject to modifications.